



PHÖNIX

STRACK

DAUME
REGELARMATUREN



Solent & Pratt
Phoenix Ltd

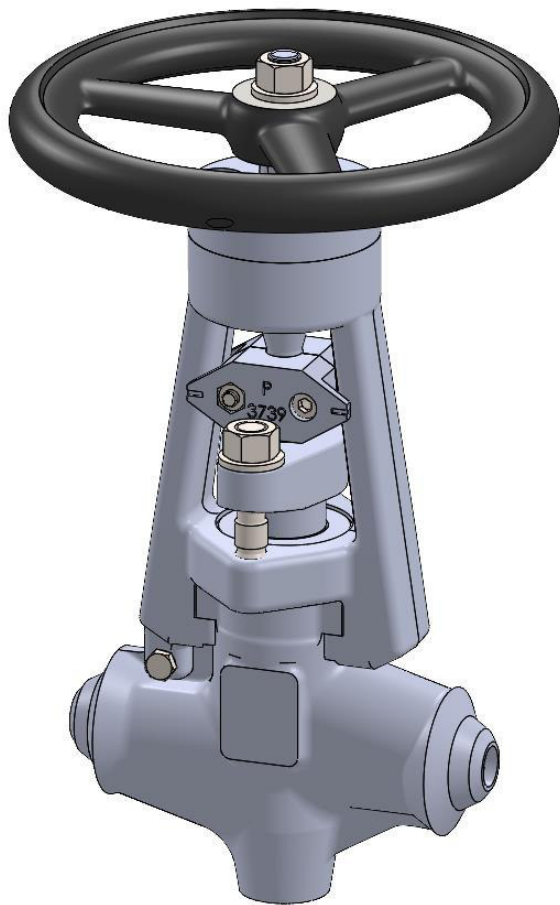

Globe Valve

Type S21

Class 600 - 2500

Phoenix Valve Group
Am Stadtbruch 6
34471 Volkmarsen

Phone:
web:
eMail:

+49 5693 988 0
www.phoenix-valvegroup.com
info@phoenix-valvegroup.com



Globe Valve / Type S21

NPS 1/2 - 2
 Cl. 600 / 900 / 1500 / 2500



Design

- With rotating rising handwheel
- Construction of forged components
- Coverless design
- With integrated stuffing seal in the body, non rotating disc and coupling stem

Dimensions of welding ends

| NPS | Schedule 40 | | | | | Schedule 80 | | | | | Schedule 160 | | | | | L | Weight (kg) |
|-------|-----------------|-----------------|------|-----|------|-----------------|-----------------|------|-----|------|-----------------|-----------------|------|-----|------|-----|-------------|
| | ØD _A | Ød _F | Øa | t | Øj | ØD _A | Ød _F | Øa | t | Øj | ØD _A | Ød _F | Øa | t | Øj | | |
| 1/2 | 21,5 | 15,5 | 21,3 | 2,8 | 15,8 | 21,5 | 13 | 21,3 | 3,7 | 13,9 | 21,5 | 11 | 21,3 | 4,8 | 11,8 | 160 | 7 |
| 3/4 | 27 | 21 | 26,7 | 2,9 | 20,9 | 27 | 18 | 26,7 | 3,9 | 18,8 | 27 | 15 | 26,7 | 5,6 | 15,5 | 160 | 7 |
| 1* | 34 | 27 | 33,4 | 3,4 | 26,6 | 34 | 24 | 33,4 | 4,5 | 24,3 | 34 | 21 | 33,4 | 6,4 | 20,7 | 160 | 7 |
| 1 1/4 | 42 | 35 | 42,2 | 3,6 | 35,1 | 42 | 32 | 42,2 | 4,8 | 32,5 | 42 | 29 | 42,2 | 6,4 | 29,5 | 250 | 27 |
| 1 1/2 | 48,5 | 41 | 48,3 | 3,7 | 40,9 | 48,5 | 38 | 48,3 | 5,1 | 38,1 | 48,5 | 34 | 48,3 | 7,1 | 34,0 | 250 | 27 |
| 2** | 60,5 | 52,5 | 60,3 | 3,9 | 52,5 | 60,5 | 49 | 60,3 | 5,5 | 49,3 | 60,5 | 43 | 60,3 | 8,7 | 42,8 | 250 | 27 |

* maximum possible diameter of Da = 49mm / ** maximum possible diameter of Da = 90mm

Drag coefficient / Flow coefficient

| NPS | 1/2 | 3/4 | 1 | 1 1/2 | 2 |
|------------------------------------|-----|-----|-----|-------|------|
| ζ _v [-] | 7 | 5,3 | 9,1 | 9,5 | 10,5 |
| k _v [m ³ /h] | 3,3 | 6,8 | 8,3 | 20 | 29 |

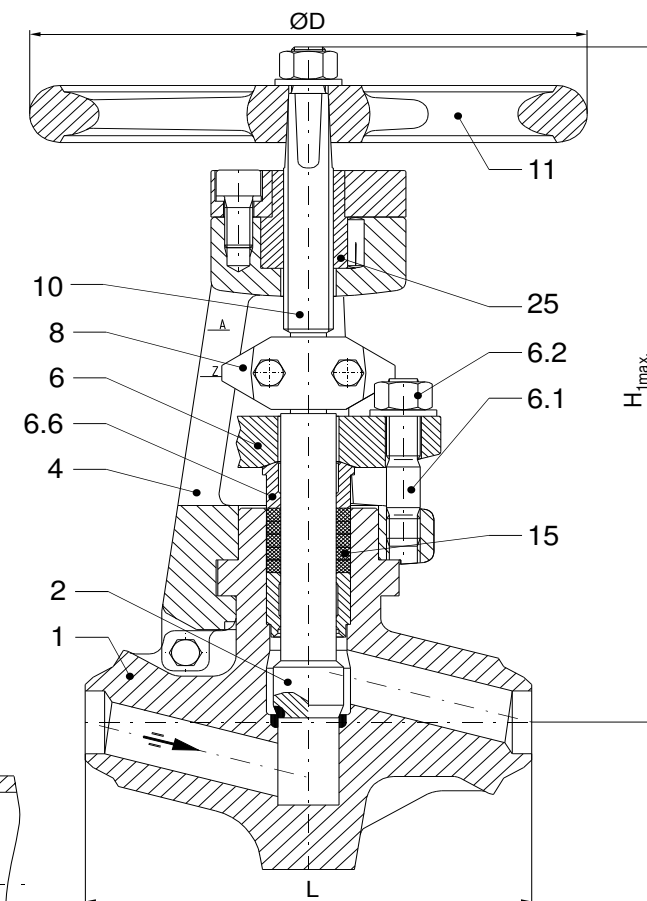
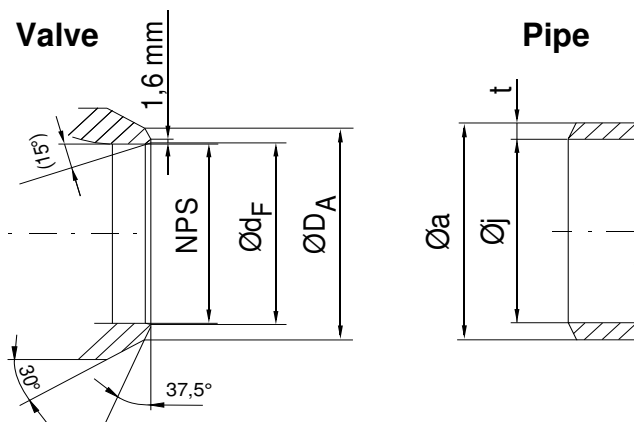

PHÖNIX reserves the right to change product design and specification without notice.

PHÖNIX • P +49 5693 988-0 • F +49 5693 988-178 • info@phoenix-valvegroup.com • https://phoenix-valvegroup.com

Globe Valve / Type S21

Cl. 600 / 900 / 1500 / 2500 NPS 1/2 - 2

Materials



| Item | Part name | Heat resistant carbon steel | Low temperature steel | Stainless steel |
|------|-------------------|---|---|--|
| | | Material * | Material* -50 °C / 500 bar 400 °C / 375 bar | Material* 20 °C / 500 bar 550 °C / 356 bar |
| 1 | Body | 20 °C / 630 bar ... 450 °C / 193 bar A 105 20 °C / 630 bar ... 530 °C / 132 bar A 182 Gr. F1 20 °C / 630 bar ... 550 °C / 137 bar A 182 Gr. F11 20 °C / 630 bar ... 600 °C / 195 bar A 182 Gr. F22 20 °C / 630 bar ... 650 °C / 123 bar A 182 Gr. F91 | A 350 Gr. LF2 | A 182 Gr.F316L |
| | Overlay | Stellite 21 (≈ 32 HRC) | Stellite 21 (≈ 32 HRC) | Stellite 21 (≈ 32 HRC) |
| 2 | Disc + Lower Stem | >10 % Cr (1.4922) | >10 % Cr (1.4922) | A 182 Gr.F316Ti |
| | Overlay | Stellite 6 (≈ 42 HRC) | Stellite 6 (≈ 42 HRC) | Stellite 6 (≈ 42 HRC) |
| 4 | Bonnet | A 182 Gr. F12 | A 182 Gr. F11 | A 182 Gr. F11 |
| 6 | Gland follower | A 182 Gr. F22 | A 182 Gr. F22 | A 182 Gr. F22 |
| 6a | Pressure piece | A 182 Gr. F12 | A 479 Gr.316Ti | A 479 Gr.316Ti |
| 8 | Coupling | A 351 CF 8M | A 351 CF 8M | A 351 CF 8M |
| 10 | Upper Stem | A 182 Gr. F6 | A 182 Gr. F6 | A 182 Gr. F6 |
| 11 | Handwheel | A 395 | A 395 | A 395 |
| 15 | Packing | Graphite | Graphite | Graphite |
| 16 | Stud bolt | A 193 Gr.B7 | A 193 Gr.B7 | A 193 Gr.B7 |
| 17 | Hex.nut | A 194 - 7L | A 194 - 7L | A 194 - 7L |
| 25 | Screwed bush | CuAl10Fe3Mn2F60 34CrAlMo5 | CuAl10Fe3Mn2F60 34CrAlMo5 | CuAl10Fe3Mn2F60 34CrAlMo5 |

Special materials on request

* Pressure-temperature-rating see appendix

Specification

| | |
|-------------------------|---|
| Marking | MSS SP-25, ISO 5209 (EN19, AD-A4, CE) |
| Face-to-face dimensions | |
| Butt weld ends | Manufacturer standard |
| Socket weld ends | Manufacturer standard |
| Connections | |
| Butt weld ends | ASME B 16.25 |
| Socket weld ends | ASME B 16.11 |
| Testing standard | API 598, ISO 5208 (AD-2000, DIN 3230 section 3) |

PHÖNIX reserves the right to change product design and specification without notice.

Contact us



Volkmarsen, Germany

Sales and Operations

Phönix Valve Group GmbH

Volkmarsen, Germany
Phone: +49 5693 988 0
Email: info@phoenix-valvegroup.com
Website: www.phoenix-valvegroup.com

Phönix Armaturen Werke-Bregel GmbH

Volkmarsen, Germany
Phone: +49 5693 988 0
Email: info@phoenix-valvegroup.com
Website: www.phoenix-valvegroup.com

Strack GmbH

Volkmarsen, Germany
Phone: +49 5693 988 0
Email: info@phoenix-valvegroup.com
Website: www.phoenix-valvegroup.com

PAW SARL

Genay Cedex, France
Phone: +33 437 408 195
Email: commercial@phoenix-valvegroup.com
Website: www.phoenix-valvegroup.com

Daume Regelarmaturen GmbH

Volkmarsen, Germany
Phone: +49 5693 988 0
Email: info@phoenix-valvegroup.com
Website: www.phoenix-valvegroup.com

Solent & Pratt Phönix Ltd.

Volkmarsen, Germany
Phone: +49 5693 988 0
Email: info@phoenix-valvegroup.com
Website: www.phoenix-valvegroup.com



While this information is presented in good faith and believed to be accurate, Phönix Valve Group GmbH, does not guarantee satisfactory results from reliance on such information. Nothing contained herein is to be construed as a warranty or guarantee, expressed or implied, regarding the performance, merchantability, fitness or any other matter with respect to the products, nor as a recommendation to use any product or process in conflict with any patent. Phönix Valve Group GmbH, reserves the right, without notice, to alter or improve the designs or specifications of the products described herein.

© 2022 Phönix Valve Group. All rights reserved. Specifications are subject to change without notice. All trademarks are property of their respective owners

Printed in Germany
09/22-R0